



### Main features

- Temperature Limits: - 80 ... + 600° C
- Tolerance: UNI 7937, IEC 751 standards:
  - ± 0.15° C at 0° C for class A (1/2 DIN)
  - ± 0.30° C at 0° C for class B (1 DIN)
  - ± 0.10° C at 0° C for class 1/3 DIN
- Compact mineral insulated (MgO) resistance thermometer element (Pt100 at 0°C) and continuous metal sheath
- Application versatility

### MODELS

**TR6M A**  
without fitting

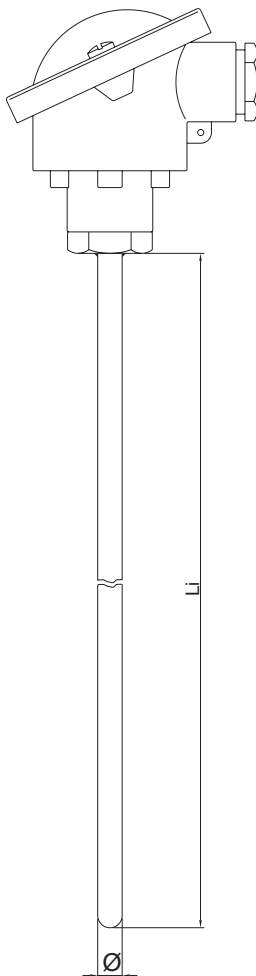

**TR6M B**  
with adjustable  
compression fitting

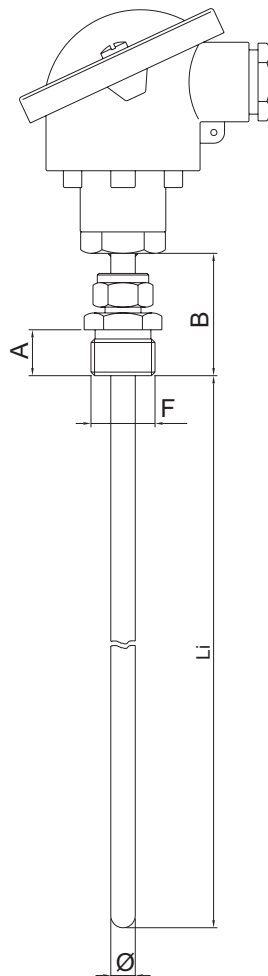

**TR6M D**  
with welded fitting  
under the head

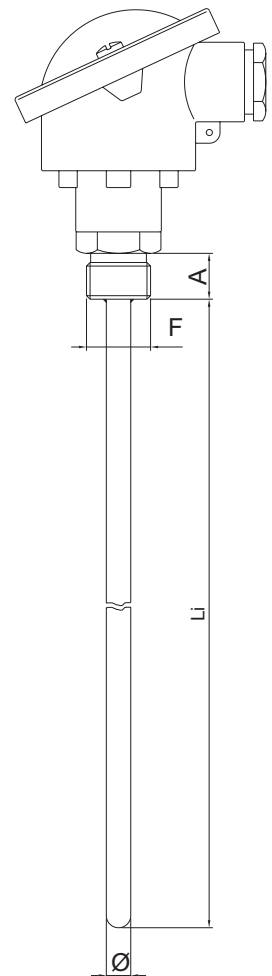

# ORDER CODE

T R 6 M

0 0 0 X 0 0 0 X

## CODE

Model	
Without fitting	A
With adjustable compression fitting	B
With welded fitting under the head	D

Element + Nr. of Wires	
Single 2 wires	1
Single 3 wires	2
Double 2 wires	3
Double 3 wires	4
Single 4 wires	5

Precision Class	
PT100 class A (1/2 DIN)	A
PT100 class B (1 DIN)	B
PT100 class (1/3 DIN)	C

Connection Head	
Mignon	A *
DIN J	B **
DIN B	C
DIN BUS	E
EEX d IIC2GD	F
CEAA	H

(\*) Available with single 2-wire element only  
 (\*\*) Not available with double 3-wire element

Sheath Material	
AISI 316	C

Sheath Diameter (mm)	
3	E*
4.5	G
6	I

(\*) Not available with double element

Connection Thread *		
1/8" GAS	"A"= 10mm	A
1/4" GAS	"A"= 12mm	B
3/8" GAS	"A"= 15mm	C
1/2" GAS	"A"= 15mm	D
1/8" NPT		G
1/4" NPT		H
3/8" NPT		I
1/2" NPT		J

(\*) To be shown for B, D models only

Connection Material *	
Nickel-Plated Brass	1**
300 Series Stainless Steel	2

(\*) To be shown for B, D models only  
 (\*\*) Available for TR6MB model only

Certificates	
A	Conformity Report

## LENGTHS AND ACCESSORIES

Li = Immersion Length (mm)	
Standard length from 50 to 2000 mm with 100 mm step	
And from 2000 to 10000 mm with 500 mm step	

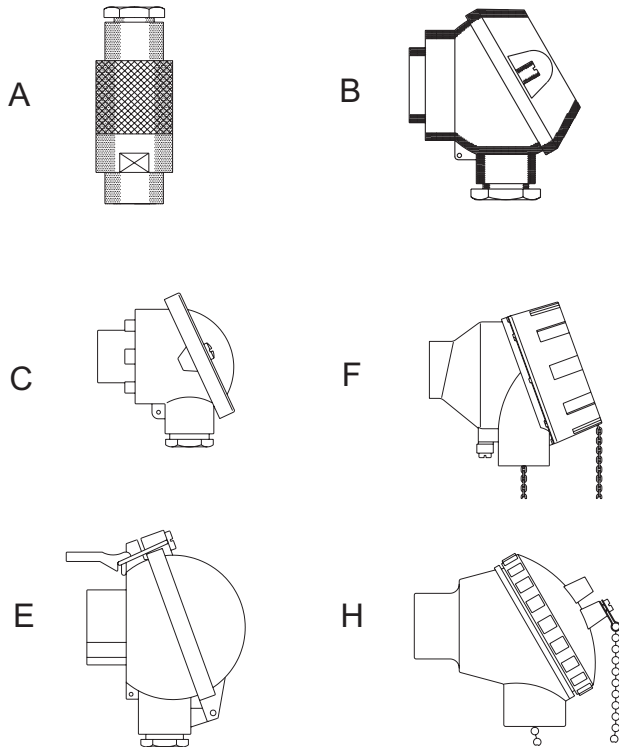

MOUNT (F)	Mod. B		Mod. D
	A (mm)	B (mm)	A (mm)
G 1/8	10	35	10
G 1/4	12	35	12
G 3/8	15	40	15
G 1/2	15	40	15
1/8 NPT	11	35	11
1/4 NPT	16	40	16
3/8 NPT	16	40	16
1/2 NPT	20	45	20

Availability of Mounts / Sheathing Diameter			
Mount (F)	ø3	ø4,5	ø6
G 1/8	x	x	x
G 1/4	x	x	x
G 3/8	-	x	x
G 1/2	-	x	x
1/8 NPT	x	x	x
1/4 NPT	x	x	x
3/8 NPT	-	x	x
1/2 NPT	-	x	x

GEFRAN spa reserves the right to make any kind of design or functional modification at any moment without prior notice

**GEFRAN spa**  
 via Sebina, 74  
 25050 PROVAGLIO D'ISEO (BS) - ITALIA  
 ph. 0309888.1 - fax. 0309839063  
 Internet: <http://www.gefran.com>  
[www.gefranonline.com](http://www.gefranonline.com)

**GEFRAN**

DTS\_TR6M\_12-2015\_ENG